

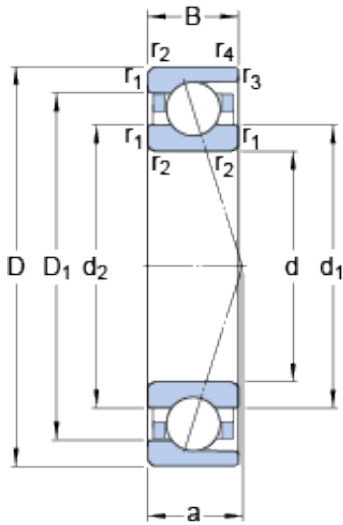

NTA PRECISION AXLE CORP.



7038 CD/P4A Bearing 2D drawings and 3D CAD models

190 mm x 290 mm x 46 mm SKF 7038 CD/P4A angular contact ball bearings

Bearing No. 7038 CD/P4A

Size	290x190x46 mm
Bore Diameter	290 mm
Outer Diameter	190 mm
Width	46 mm
d	190 mm
D	290 mm
B	46 mm
d ₁	221.8 mm
d ₂	221.8 mm
D ₁	258.2 mm
r _{1,2} - min.	2.1 mm
r _{3,4} - min.	1.1 mm
a	55.3 mm
d _a - min.	201 mm
d _b - min.	201 mm
D _a - max.	279 mm
D _b - max.	284 mm
r _a - max.	2 mm
r _b - max.	1 mm
d _n	229.7 mm
Basic dynamic load rating - C	247 kN
Basic static load rating - C ₀	305 kN
Fatigue load limit - P _u	8.3 kN
Limiting speed for grease	4800 r/min



NTA PRECISION AXLE CORP.

Lubrication	
Limiting speed for oil lubrication	7000 mm/min
Ball - D_w	30.162 mm
Ball - z	22
G_{ref}	114 cm3
Calculation factor - f_0	15.9
Preload class A - G_A	950 N
Preload class B - G_B	1900 N
Preload class C - G_C	3800 N
Preload class D - G_D	7600 N
Calculation factor - f	1.14
Calculation factor - f	1
Calculation factor - f_{2A}	1
Calculation factor - f_{2B}	1.02
Calculation factor - f_{2C}	1.05
Calculation factor - f_{2D}	1.09
Calculation factor - f_{HC}	1
Preload class A	196 N/micron
Preload class B	266 N/micron
Preload class C	370 N/micron
Preload class D	532 N/micron
Category	Precision Ball Bearings
Inventory	0.0
Manufacturer Name	SKF
Minimum Buy Quantity	N/A
Weight / Kilogram	0
Product Group	B04270
Enclosure	Open
Precision Class	ABEC 7 ISO P4



NTA PRECISION AXLE CORP.

Material - Ball	Steel
Number of Bearings	1 (Single)
Contact Angle	15 Degree
Preload	None
Raceway Style	1 Rib Outer Ring
Cage Material	Phenolic
Rolling Element	Ball Bearing
Flush Ground	No
Inch - Metric	Metric
Other Features	Single Row Angular Contact High Capacity Basic Design
Long Description	190MM Bore; 290MM Outside Diameter; 46MM Width; Open Enclosure; ABEC 7 ISO P4 Precision; Steel Ball Material; 1 (Single) Bearing; 15 Degree Contact Angle; Phenolic Cage Material; 1 Rib Outer Ring Ra
Category	Precision Ball Bearings
UNSPSC	31171531
Harmonized Tariff Code	8482.10.50.28
Noun	Bearing
Keyword String	Ball Angular Contact
Manufacturer URL	http://www.skf.com
Bore	7.48 Inch 190 Millimeter
Width	1.811 Inch 46 Millimeter
Outside Diameter	11.417 Inch 290 Millimeter
d ₁	221.8 mm
d ₂	221.8 mm
D ₁	258.2 mm
r _{1,2} min.	2.1 mm
r _{3,4} min.	1.1 mm



NTA PRECISION AXLE CORP.

d_a min.	201 mm
d_b min.	201 mm
D_a max.	279 mm
D_b max.	284 mm
r_a max.	2 mm
r_b max.	1 mm
d_n	229.7 mm
Basic dynamic load rating C	247 kN
Basic static load rating C_0	305 kN
Fatigue load limit P_u	8.3 kN
Attainable speed for grease lubrication	4800 r/min
Attainable speed for oil-air lubrication	7000 r/min
Ball diameter D_w	30.162 mm
Number of balls z	22
Reference grease quantity G_{ref}	114 cm ³
Preload class A G_A	950 N
Static axial stiffness, preload class A	196 N/ μ m
Preload class B G_B	1900 N
Static axial stiffness, preload class B	266 N/ μ m
Preload class C G_C	3800 N
Static axial stiffness, preload class C	370 N/ μ m
Preload class D G_D	7600 N
Static axial stiffness, preload class D	532 N/ μ m
Calculation factor f	1.14
Calculation factor f_1	1
Calculation factor f_{2A}	1
Calculation factor f_{2B}	1.02



NTA PRECISION AXLE CORP.

Calculation factor f_{2C}	1.05
Calculation factor f_{2D}	1.09
Calculation factor f_{HC}	1
Calculation factor f_0	15.9
Mass bearing	9.51 kg