

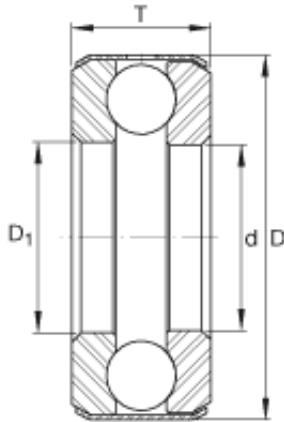

NTA PRECISION AXLE CORP.



INA D12 thrust ball bearings

Bearing No. D12

D12 Bearing 2D drawings and 3D CAD models

Size	30.163x53.188x15.875 mm
Bore Diameter	30,163 mm
Outer Diameter	53,188 mm
Width	15,875 mm
d	1 3/16 inch
d	30,163 mm
D	2,094 inch
D	53,188 mm
T	0,625 inch
T	15,875 mm
D ₁	1,219 inch
m	0,31 lbs / Weight
m	142 g / Weight
C _a	6900 lbf / Dynamic load rating (axial)
C _a	30700 N / Dynamic load rating (axial)
C _{0a}	14000 lbf / Static load rating (axial)
C _{0a}	62000 N / Static load rating (axial)
Category	Thrust Ball Bearing
Inventory	0.0
Manufacturer Name	SCHAEFFLER GROUP
Minimum Buy Quantity	N/A
Weight / Kilogram	0.17
EAN	4012802859119



NTA PRECISION AXLE CORP.

Product Group	B00308
Rolling Element	Ball Bearing
Thrust Bearing	Yes
Single or Double Direction	Single Direction
Banded	Yes
Precision Class	ABEC 1 ISO P0
Component Description	Roller Assembly Plus Raceways
Other Features	Single Row Deep Groove Medium Cross Section Grooved Race Non Separable Full Complement Standard Oil Hole in Band
Long Description	1-3/16" Bore 1; 1-7/32" Bore 2; 2-3/32" Outside Diameter; 5/8" Height; Ball Bearing; Single Direction; Banded; ABEC 1 ISO P0 Precision
Inch - Metric	Inch
Category	Thrust Ball Bearings
UNSPSC	31171507
Harmonized Tariff Code	8482.10.50.08
Noun	Bearing
Keyword String	Ball Thrust
Manufacturer URL	http://www.ina.com
Manufacturer Item Number	D12AKL
Weight / LBS	0.31
Bore 1	1.188 Inch 30.175 Millimeter
Bore 2	1.219 Inch 30.963 Millimeter
Outside Diameter	2.094 Inch 53.188 Millimeter
Overall Height with Aligning Washer	0 Inch 0 Millimeter



NTA PRECISION AXLE CORP.

Height

0.625 Inch | 15.875
Millimeter